

Technical leaflet

**Stop valves,**  
Type SVA-ST and SVA-LT 15 (1/2 in.) - 200 (8 in.)



**Contents**

Page

|   |    |
|---|----|
| Introduction .....  | 3  |
| Features .....  | 3  |
| Additional features for low temperature version (SVA-LT) .....                | 3  |
| Technical data .....  | 4  |
| Design .....  | 4  |
| Connections .....   | 5  |
| Material specification .....  | 6  |
| SVA-ST and SVA-LT 15 - 40 (1/2 - 11/2 in.) .....                              | 6  |
| SVA-ST and SVA-LT 50 - 65 (2 - 21/2 in.) .....                                | 7  |
| SVA-ST and SVA-LT 80 - 200 (3 - 8 in.) .....                                  | 8  |
| Dimensions and weights .....  | 9  |
| SVA 15 - 40 (1/2 - 11/2 in. ) in angleway version with cap / hand wheel ..... | 9  |
| SVA 15 - 40 (1/2 - 11/2 in. ) straightway version with cap / hand wheel ..... | 10 |
| SVA 50 - 65 (2 - 21/2 in.) in angleway version with cap / hand wheel .....    | 11 |
| SVA 50 - 65 (2 - 21/2 in.) in straightway version with cap / hand wheel ..... | 12 |
| SVA 80 - 200 (3 - 8 in.) angleway version with cap / hand wheel .....         | 13 |
| SVA 80 - 200 (3 - 8 in.) straightway version with cap / hand wheel .....      | 14 |
| Ordering .....  | 15 |

## Introduction



SVA are angleway and straightway stop valves which are designed to meet all industrial refrigeration application requirements.

The valves are designed to give favourable flow characteristics and are easy to dismantle and repair when necessary. The valve cone is designed to ensure perfect closing.

## Features

- Applicable to all common refrigerants including R 717 and non corrosive gases/ liquids dependent on sealing material compatibility
- Optional accessories:
  - Heavy duty industrial hand wheel for frequent operation
  - Vented cap for infrequent operation
- Available in angleway and straightway versions with standard bonnet or extended bonnet for insulated systems
- Each valve type is clearly marked with type, size and performance range
- The valves and caps are prepared for sealing, to prevent operation by unauthorized persons, using a seal wire
- Internal metal backseating
  - DN 15 - 65 (1/2 - 2 1/2 in.)
  - Internal PTFE backseating
    - DN 80 - 200 (3 - 8 in.)
- Can accept flow in both directions
- Standard bonnet is suitable for installation in normal insulated systems
- Material on housing and bonnet are in low temperature steel according to requirements of the Pressure Equipment Directive and other international classification authorities
- Pressure range:
  - Standard version*
  - SVA-ST: 40 bar g (580 psi g)
- Temperature range:
  - Standard version*
  - 50/+150°C (-58/+302°F)
- Classification: DNV, LR, SAQ, CRN, BV etc. To get an updated list of certification on the products please contact your local Danfoss Sales Company

**Additional features for low temperature version (SVA-LT)**

- Low temperature version with extended bonnet for insulated low temperature applications
- Special springloaded low temperature spindle seal
- Pressure range:
  - Low temperature version*
  - SVA-LT: 40 bar g (580 psi g)
- Temperature range:
  - Low temperature version*
  - 60/+150°C (-76/+302°F)
- Stainless steel bolts

**Design**

**Connections**

Available with the following connections:

- Butt-weld DIN (2448)
- Butt-weld ANSI (B 36.10 Schedule 80),  
- DN 15 - 40 (1/2 - 1 1/2 in.)
- Butt-weld ANSI (B 36.10 Schedule 40),  
- DN 50 - 200 (2 - 8 in.)
- Socket Weld (ANSI B 16.11),  
- DN 15 - DN 50 (1/2 - 2 in.)
- FPT Female Pipe Thread, NPT  
(ANSI/ASME B 1.20.1) ,  
- DN 15 - 32 (1/2 - 1 1/4 in.)

**Housing**

Made of special, cold resistant steel approved for low temperature operations.

**Valve cone**

The valve cone can be turned on the spindle, thus there will be no friction between the cone and the seat, when the valve is opened and closed. A teflon tightening ring provides perfect sealing at a minimum closing momentum.

**Spindle**

Made of polished stainless steel, ideal for O-ring sealing.

**Packing gland**

Standard version (ST):

The standard packing gland ensures a perfect tightness in the range: -50/+150°C (-58/+302°F). The packing glands are equipped with a scraper ring to prevent penetration of dirt and ice into the packing gland.

Low temperature version (LT):

This comprises a springloaded seal packing gland which ensures a perfect tightness in the range: -60/+150°C (-76/+302°F). The packing glands are equipped with a scraper ring to prevent penetration of dirt and ice into the packing gland.

**Pressure Equipment Directive (PED)**

SVA-ST and LT valves are approved according to the European standard specified in the Pressure Equipment Directive and are CE marked.

For further details / restrictions - see Installation Instruction.

**Installation**

It is recommended that the valves be installed in the direction of flow indicated by the arrow on the valve body. The valve can be installed in the opposite direction but this slightly reduces the  $k_v$ -value ( $C_v$ -value).

The valve is designed to withstand high internal pressure. However, the piping system in general should be designed to avoid liquid traps and reduce the risk of hydraulic pressure caused by thermal expansion.

For further information refer to installation instructions for SVA ST and LT.

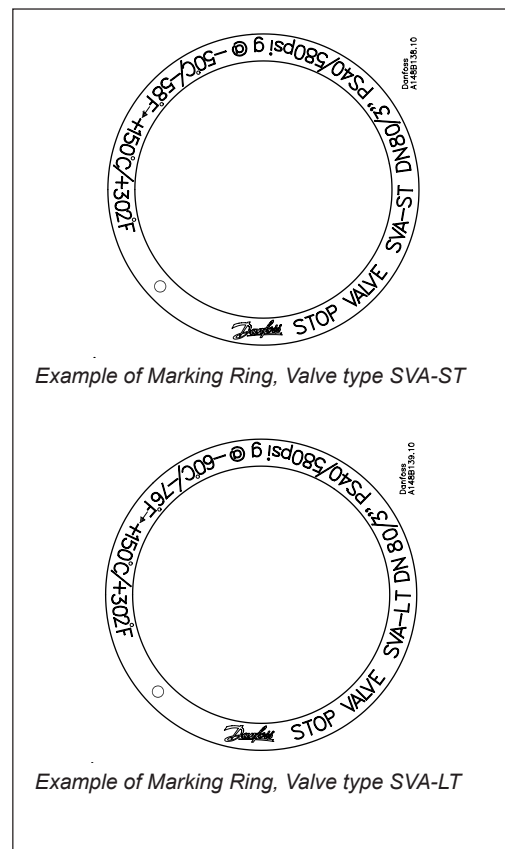

Example of Marking Ring, Valve type SVA-ST

Example of Marking Ring, Valve type SVA-LT



| SVA-ST and LT valves |                        |                            |                            |
|----------------------|------------------------|----------------------------|----------------------------|
| Nominal bore         | DN ≤ 25 mm (1 in.)     | DN32-80 mm (1 1/4 - 3 in.) | DN100 - 200 mm (4 - 8 in.) |
| Classified for       | Fluid group I          |                            |                            |
| Category             | Article 3, paragraph 3 | II                         | III                        |

**Technical data**

- Refrigerants  
Applicable to all common non flammable refrigerants including R 717 and non corrosive gases/liquids dependent on sealing material compatibility.  
For further information please see installation instruction for SVA ST and LT.
- Flammable hydrocarbons are not recommended. For further information please contact your local Danfoss Sales Company.

- Temperature Range  
Standard version (ST):  
-50/+150°C (-58/+302°F).  
  
Low temperature version (LT):  
-60/+150°C (-76/+302°F).
- Pressure range  
The valves are designed for max. working pressure 40 bar g (580 psi g), for both standard and low temperature versions.

## Connections

## DIN

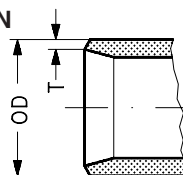

| Size<br>mm | Size<br>in. | OD<br>mm | T<br>mm | OD<br>in. | T<br>in. |  |  | $k_v$ -angle<br>m <sup>3</sup> /h | $k_v$ -straight<br>m <sup>3</sup> /h | $C_v$ -angle<br>USgal/min | $C_v$ -straight<br>USgal/min |
|------------|-------------|----------|---------|-----------|----------|--|--|-----------------------------------|--------------------------------------|---------------------------|------------------------------|
|------------|-------------|----------|---------|-----------|----------|--|--|-----------------------------------|--------------------------------------|---------------------------|------------------------------|

## Butt-weld DIN (2448)

|     |       |       |     |       |       |  |  |      |      |      |      |
|-----|-------|-------|-----|-------|-------|--|--|------|------|------|------|
| 15  | 1/2   | 21.3  | 2.3 | 0.839 | 0.091 |  |  | 7.0  | 4.9  | 8.1  | 5.7  |
| 20  | 3/4   | 26.9  | 2.3 | 1.059 | 0.091 |  |  | 14.6 | 10.2 | 16.9 | 11.8 |
| 25  | 1     | 33.7  | 2.6 | 1.327 | 0.103 |  |  | 24.8 | 17.4 | 28.8 | 20.2 |
| 32  | 1 1/4 | 42.4  | 2.6 | 1.669 | 0.102 |  |  | 42.6 | 29.8 | 49.4 | 34.6 |
| 40  | 1 1/2 | 48.3  | 2.6 | 1.902 | 0.103 |  |  | 45.2 | 31.6 | 52.4 | 36.7 |
| 50  | 2     | 60.3  | 2.9 | 2.37  | 0.11  |  |  | 80   | 65   | 93   | 76   |
| 65  | 2 1/2 | 76.1  | 2.9 | 3     | 0.11  |  |  | 120  | 97   | 140  | 113  |
| 80  | 3     | 88.9  | 3.2 | 3.50  | 0.13  |  |  | 182  | 152  | 211  | 176  |
| 100 | 4     | 114.3 | 3.6 | 4.50  | 0.14  |  |  | 313  | 278  | 363  | 323  |
| 125 | 5     | 139.7 | 4.0 | 5.50  | 0.16  |  |  | 514  | 470  | 596  | 545  |
| 150 | 6     | 168.3 | 4.5 | 6.63  | 0.18  |  |  | 785  | 597  | 911  | 693  |
| 200 | 8     | 219.1 | 6.3 | 8.63  | 0.25  |  |  | 1168 | 1024 | 1355 | 1188 |

## ANSI

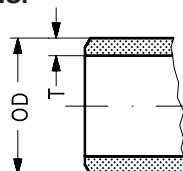

| Size<br>mm | Size<br>in. | OD<br>mm | T<br>mm | OD<br>in. | T<br>in. |  |  | $k_v$ -angle<br>m <sup>3</sup> /h | $k_v$ -straight<br>m <sup>3</sup> /h | $C_v$ -angle<br>USgal/min | $C_v$ -straight<br>USgal/min |
|------------|-------------|----------|---------|-----------|----------|--|--|-----------------------------------|--------------------------------------|---------------------------|------------------------------|
|------------|-------------|----------|---------|-----------|----------|--|--|-----------------------------------|--------------------------------------|---------------------------|------------------------------|

## Butt-weld ANSI (B 36.10 Schedule 80)

|    |       |      |     |       |       |  |  |      |      |      |      |
|----|-------|------|-----|-------|-------|--|--|------|------|------|------|
| 15 | 1/2   | 21.3 | 3.7 | 0.839 | 0.146 |  |  | 7.0  | 4.9  | 8.1  | 5.7  |
| 20 | 3/4   | 26.9 | 4.0 | 1.059 | 0.158 |  |  | 14.6 | 10.2 | 16.9 | 11.8 |
| 25 | 1     | 33.7 | 4.6 | 1.327 | 0.181 |  |  | 24.8 | 17.4 | 28.8 | 20.2 |
| 32 | 1 1/4 | 42.4 | 4.9 | 1.669 | 0.193 |  |  | 42.6 | 29.8 | 49.4 | 34.6 |
| 40 | 1 1/2 | 48.3 | 5.1 | 1.902 | 0.201 |  |  | 45.2 | 31.6 | 52.4 | 36.7 |

## Butt-weld ANSI (B 36.10 Schedule 40)

|     |       |       |     |      |      |  |  |      |      |      |      |
|-----|-------|-------|-----|------|------|--|--|------|------|------|------|
| 50  | 2     | 60.3  | 3.9 | 2.37 | 0.15 |  |  | 80   | 65   | 93   | 76   |
| 65  | 2 1/2 | 73.0  | 5.2 | 2.87 | 0.20 |  |  | 120  | 97   | 140  | 113  |
| 80  | 3     | 88.9  | 5.5 | 3.50 | 0.22 |  |  | 182  | 152  | 211  | 176  |
| 100 | 4     | 114.3 | 6.0 | 4.50 | 0.24 |  |  | 313  | 278  | 363  | 323  |
| 125 | 5     | 141.3 | 6.6 | 5.56 | 0.26 |  |  | 514  | 470  | 596  | 545  |
| 150 | 6     | 168.3 | 7.1 | 6.63 | 0.28 |  |  | 785  | 597  | 911  | 693  |
| 200 | 8     | 219.1 | 8.2 | 8.63 | 0.32 |  |  | 1168 | 1024 | 1355 | 1188 |

| Size<br>mm | Size<br>in. | ID<br>mm | T<br>mm | ID<br>in. | T<br>in. | L<br>mm | L<br>in. | $k_v$ -angle<br>m <sup>3</sup> /h | $k_v$ -straight<br>m <sup>3</sup> /h | $C_v$ -angle<br>USgal/min | $C_v$ -straight<br>USgal/min |
|------------|-------------|----------|---------|-----------|----------|---------|----------|-----------------------------------|--------------------------------------|---------------------------|------------------------------|
|------------|-------------|----------|---------|-----------|----------|---------|----------|-----------------------------------|--------------------------------------|---------------------------|------------------------------|

## Socket welding ANSI (B 16.11)

|    |       |      |     |       |       |    |      |      |      |      |      |
|----|-------|------|-----|-------|-------|----|------|------|------|------|------|
| 15 | 1/2   | 21.8 | 6.0 | 0.858 | 0.235 | 10 | 0.39 | 7.0  | 4.9  | 8.1  | 5.7  |
| 20 | 3/4   | 27.2 | 4.6 | 1.071 | 0.181 | 13 | 0.51 | 10.0 | 7.0  | 11.9 | 8.1  |
| 25 | 1     | 33.9 | 7.2 | 1.335 | 0.284 | 13 | 0.51 | 24.8 | 17.4 | 28.8 | 20.2 |
| 32 | 1 1/2 | 42.7 | 6.1 | 1.743 | 0.240 | 13 | 0.51 | 42.6 | 29.8 | 49.4 | 34.6 |
| 40 | 1 1/2 | 48.8 | 6.6 | 1.921 | 0.260 | 13 | 0.51 | 45.2 | 31.6 | 52.4 | 36.7 |
| 50 | 2     | 61.2 | 6.2 | 2.41  | 0.24  | 16 | 0.63 | 80   | 65   | 93   | 76   |

| Size<br>mm | Size<br>in. | Inside pipe thread |  |  | $k_v$ -angle<br>m <sup>3</sup> /h | $k_v$ -straight<br>m <sup>3</sup> /h | $C_v$ -angle<br>USgal/min | $C_v$ -straight<br>USgal/min |
|------------|-------------|--------------------|--|--|-----------------------------------|--------------------------------------|---------------------------|------------------------------|
|------------|-------------|--------------------|--|--|-----------------------------------|--------------------------------------|---------------------------|------------------------------|

## FPT inside pipe thread, NPT (ANSI/ASME B 1.20.1)

|    |       |                    |  |  |     |      |      |      |
|----|-------|--------------------|--|--|-----|------|------|------|
| 15 | 1/2   | (1/2 × 14 NPT)     |  |  | 8.5 | 6.0  | 9.9  | 7.0  |
| 20 | 3/4   | (3/4 × 14 NPT)     |  |  | 10  | 7.0  | 11.6 | 8.1  |
| 25 | 1     | (1 × 11.5 NPT)     |  |  | 32  | 22.4 | 37.1 | 26.0 |
| 32 | 1 1/4 | (1 1/4 × 11.5 NPT) |  |  | 36  | 25.2 | 41.8 | 29.3 |

## SOC

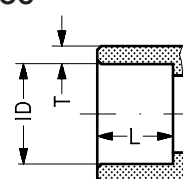

## FPT

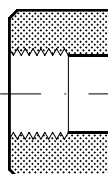

Material specification

SVA-ST and SVA-LT 15 - 40 (1/2 - 1 1/2 in.)

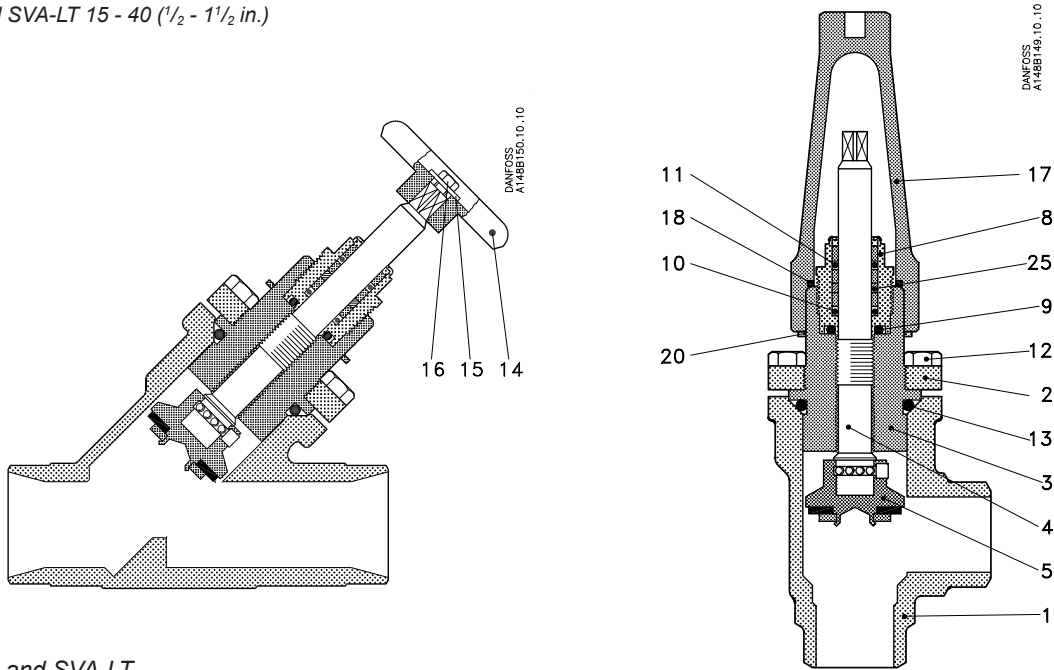

SVA-ST and SVA-LT

| No.   | Part   | Material                               | DIN                  | ISO               | ASTM             |
|-------|--|--|----------------------|-------------------|------------------|
| 1     | Housing  | Steel                                  | P285 QH<br>EN10222-4 |                   | LF2A350          |
| 2     | Bonnet, flange   | Steel                                  | P285 QH<br>EN10222-4 |                   | LF2A350          |
| 3     | Bonnet, Insert   | Steel                                  | 9SMn28<br>1651       | Type 2<br>R 683/9 | 1213<br>SAE J403 |
| 4     | Spindle  | Stainless steel                        | X10CrNiS189<br>17440 | Type 17<br>683/13 | AISI 303         |
| 5     | Cone<br>Cone seal  | Steel<br>Teflon (PTFE)                 | 9SMn28, 1651         | Type 2, R 683/9   | 1213, SAE J403   |
| 8     | Packing gland  | Steel                                  | 9SMn28, 1651         | Type 2, R 683/9   | 1213, SAE J403   |
| 9     | Packing washer<br>- DN 15 - 20 (1/2 - 3/4 in.)<br>O-ring<br>- DN 25 - 40 (1 - 1 1/2 in.) | Aluminium<br><br>Cloroprene (Neoprene) |                      |                   |                  |
| 10-11 | O-ring   | Cloroprene (Neoprene)                  |                      |                   |                  |
| 13    | O-ring   | Cloroprene (Neoprene)                  |                      |                   |                  |
| 14    | Hand wheel   | Steel                                  |                      |                   |                  |
| 15    | Washer   | Stainless steel (A2)                   |                      |                   |                  |
| 16    | Screw  | Stainless steel (A2)                   |                      |                   |                  |
| 17    | Cap  | Aluminium                              |                      |                   |                  |
| 18    | Gasket for cap   | Nylon                                  |                      |                   |                  |
| 20    | Identification ring  | Stainless steel                        |                      |                   |                  |

SVA-ST

|    |       |       |              |              |         |
|----|-------|-------|--------------|--------------|---------|
| 12 | Bolts | Steel | Quality 8.8* | Quality 8.8* | Grade 5 |
|----|-------|-------|--------------|--------------|---------|

SVA-LT

|    |                  |                        |       |       |          |
|----|------------------|------------------------|-------|-------|----------|
| 12 | Bolts            | Stainless steel        | A2-70 | A2-70 | Type 308 |
| 25 | U-sleeve sealing | PTFE + Stainless steel |       |       |          |

\*) Special alloy for low temperature application. Alternatively A2-70.

**Material specification**

SVA-ST and SVA-LT 50 - 65 (2 - 2 1/2 in.)

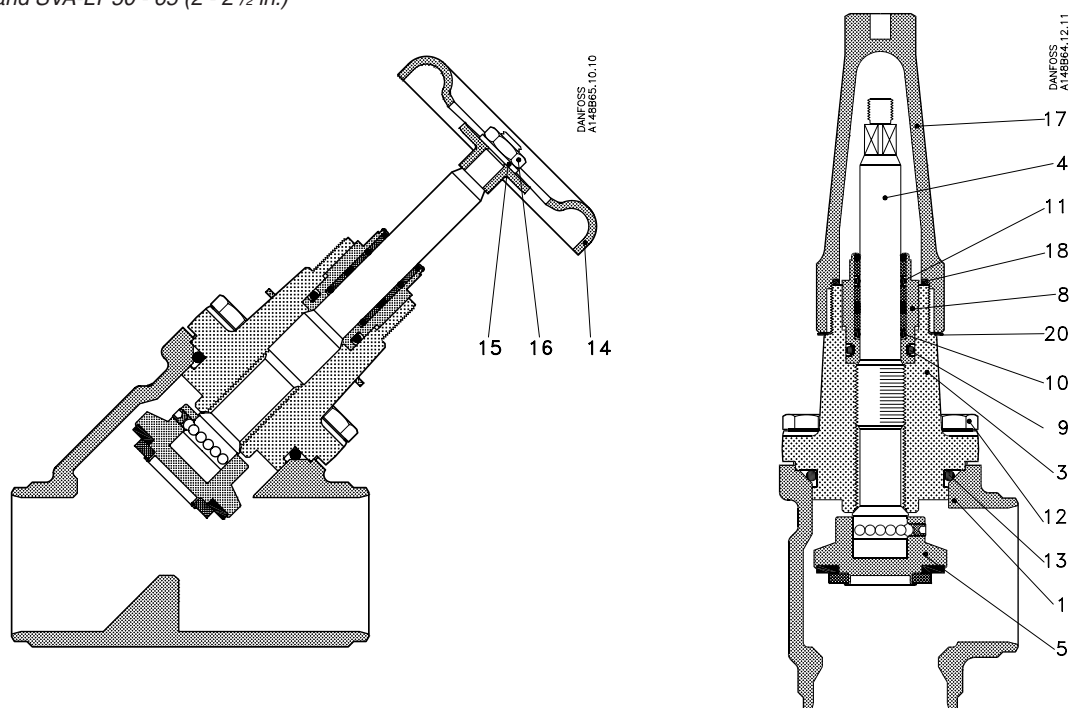

SVA-ST and SVA-LT

| No. | Part                | Material               | DIN                  | ISO                 | ASTM           |
|-----|---------------------|------------------------|----------------------|---------------------|----------------|
| 1   | Housing             | Steel                  | P285 QH<br>EN10222-4 |                     | LF2A350        |
| 3   | Valve bonnet        | Steel                  | P285 QH<br>EN10222-4 |                     | LF2A350        |
| 4   | Spindle             | Stainless steel        | X8CrNiS18-9<br>17440 | Type 17<br>R 683/13 | AISI 303       |
| 5   | Cone<br>Cone seal   | Steel<br>Teflon (PTFE) | 9SMn28, 1651         | Type 2, R 683/13    | 1213, SAE J403 |
| 8   | Packing Gland       | Steel                  | 9SMn28, 1651         | Type 2, R 683/9     | 1213, SAE J403 |
| 9   | O-ring              | Cloroprene (Neoprene)  |                      |                     |                |
| 11  | O-ring              | Cloroprene (Neoprene)  |                      |                     |                |
| 13  | O-ring              | Cloroprene (Neoprene)  |                      |                     |                |
| 14  | Hand wheel          | Steel                  |                      |                     |                |
| 15  | Washer              | Stainless steel (A2)   |                      |                     |                |
| 16  | Nut                 | Stainless steel (A2)   |                      |                     |                |
| 17  | Cap                 | Aluminium              |                      |                     |                |
| 18  | Gasket for cap      | Nylon (PA 6)           |                      |                     |                |
| 20  | Identification ring | Stainless steel        |                      |                     |                |

SVA-ST

|    |        |                       |              |              |         |
|----|--------|-----------------------|--------------|--------------|---------|
| 10 | O-ring | Cloroprene (Neoprene) |              |              |         |
| 12 | Bolts  | Steel                 | Quality 8.8* | Quality 8.8* | Grade 5 |

SVA-LT

|    |                 |                        |       |       |          |
|----|-----------------|------------------------|-------|-------|----------|
| 10 | U-sleve sealing | PTFE + Stainless steel |       |       |          |
| 12 | Bolts           | Stainless steel        | A2-70 | A2-70 | Type 308 |

\*) Special alloy for low temperature application. Alternatively A2-70.

**Material specification**

SVA-ST and SVA-LT 80 - 200 (3 - 8 in.)

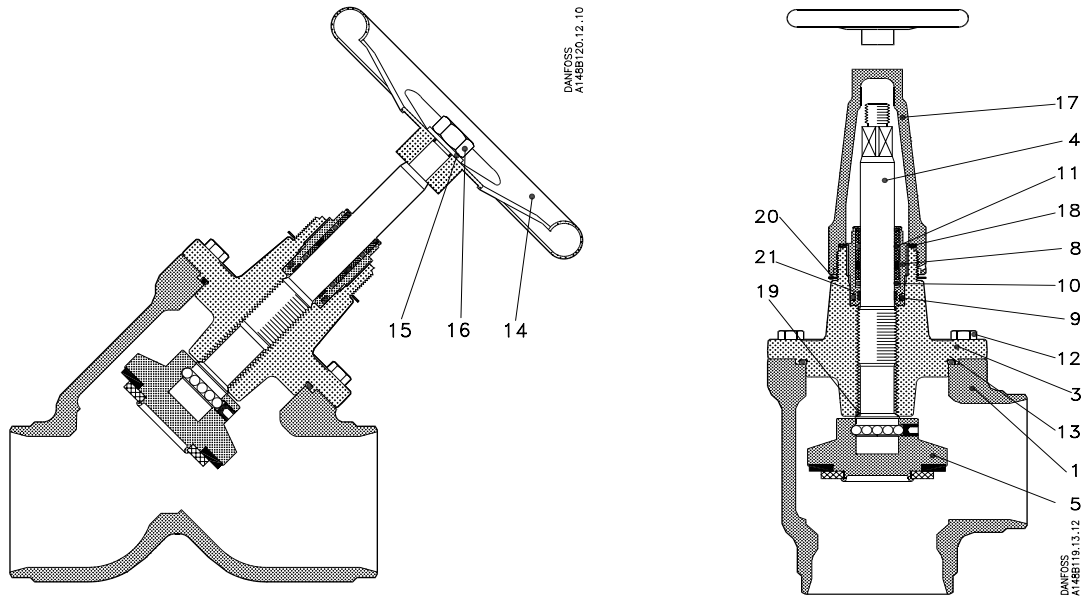

**SVA-ST and SVA-LT**

| No. | Part                | Material               | DIN                  | ISO                | ASTM              |
|-----|---------------------|------------------------|----------------------|--------------------|-------------------|
| 1   | Housing             | Steel                  | G20Mn5 QT<br>SEW 685 |                    | LCC, A352         |
| 3   | Valve bonnet        | Steel                  | P285 QH<br>EN10222-4 | TW6, 2604/3        | LF2A350           |
| 4   | Spindle             | Stainless steel        | X5CrNi1810<br>17440  | Type 11,<br>683/13 | AISI 304,<br>A276 |
| 5   | Cone<br>Cone seal   | Steel<br>Teflon (PTFE) | 9SMn28, 1651         | Type 2, R 683/9    | 1213, SAE J403    |
| 8   | Packing Gland       | Steel                  | 9SMn28, 1651         | Type 2, R 683/9    | 1213, SAE J403    |
| 9   | O-ring              | Cloroprene (Neoprene)  |                      |                    |                   |
| 11  | O-ring              | Cloroprene (Neoprene)  |                      |                    |                   |
| 13  | O-ring              | Cloroprene (Neoprene)  |                      |                    |                   |
| 14  | Hand wheel          | Steel                  |                      |                    |                   |
| 15  | Washer              | Stainless steel        |                      |                    |                   |
| 16  | Nut                 | Stainless steel        |                      |                    |                   |
| 17  | Cap                 | Aluminium              |                      |                    |                   |
| 18  | Gasket for cap      | Nylon (PA 6)           |                      |                    |                   |
| 19  | Soft backseat       | Teflon (PTFE)          |                      |                    |                   |
| 20  | Identification ring | Stainless steel        |                      |                    |                   |
| 21  | Wear ring           | Teflon (PTFE)          |                      |                    |                   |

**SVA-ST**

|    |        |                       |              |              |         |
|----|--------|-----------------------|--------------|--------------|---------|
| 10 | O-ring | Cloroprene (Neoprene) |              |              |         |
| 12 | Bolts  | Steel                 | Quality 8.8* | Quality 8.8* | Grade 5 |

**SVA-LT**

|    |                  |                        |       |       |          |
|----|------------------|------------------------|-------|-------|----------|
| 10 | U-sleeve sealing | PTFE + Stainless steel |       |       |          |
| 12 | Bolts            | Stainless steel        | A2-70 | A2-70 | Type 308 |

\*) Special alloy for low temperature application. Alternatively A2-70.

## Dimensions and weights

SVA 15 - 40 (1/2 - 1 1/2 in. ) in angleway version with cap / hand wheel

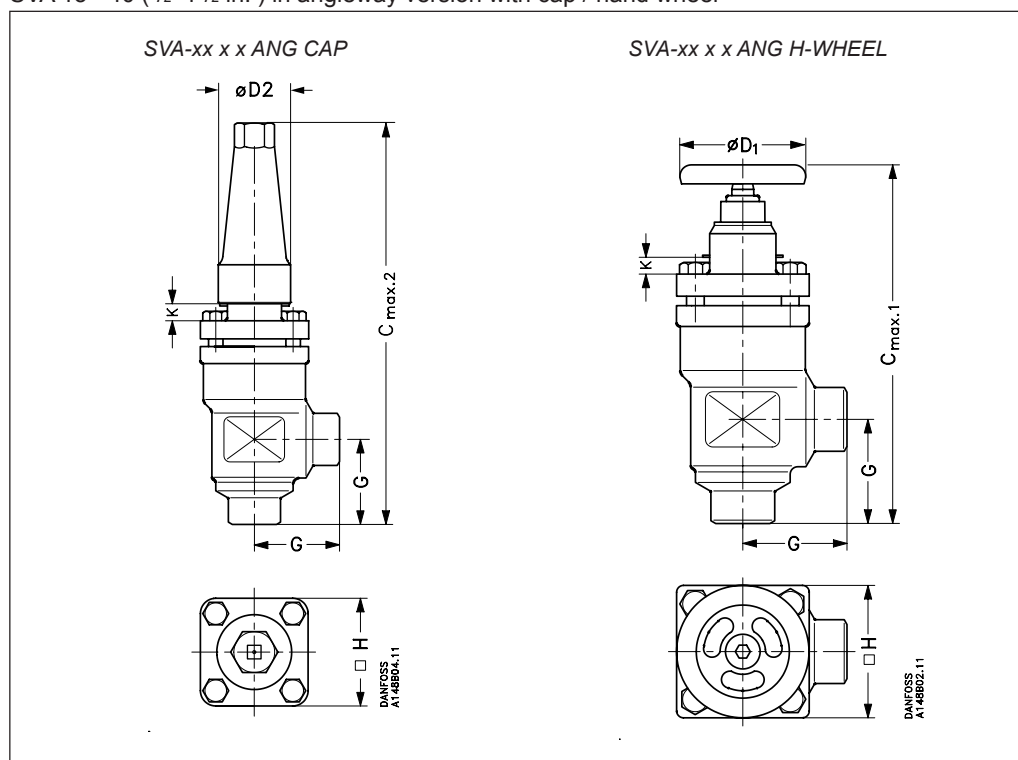

| Valve size                 | K    | C <sub>max.1</sub> | C <sub>max.2</sub> | G    | ØD <sub>1</sub> | ØD <sub>2</sub> | □H   | Weight |
|----------------------------|------|--------------------|--------------------|------|-----------------|-----------------|------|--------|
| <b>SVA-ST</b>              |      |                    |                    |      |                 |                 |      |        |
| SVA 15 - 20 mm             | 4    | 178                | 189                | 45   | 60              | 38              | 60   | 1.4 kg |
| SVA (1/2 - 3/4) in.        | 0.16 | 7.00               | 7.44               | 1.77 | 2.36            | 1.5             | 2.36 | 3.1 lb |
| SVA 25 - 40 mm             | 12   | 234                | 268                | 55   | 80              | 50              | 70   | 2.4 kg |
| SVA (1 - 1 1/2) in.        | 0.47 | 9.21               | 10.55              | 2.17 | 3.15            | 1.97            | 2.76 | 5.3 lb |
| <b>SVA-ST, Socket weld</b> |      |                    |                    |      |                 |                 |      |        |
| SVA 32 - 40 mm             | 12   | 241                | 275                | 62   | 80              | 50              | 70   | 2.9 kg |
| SVA (1 1/4 - 1 1/2) in.    | 0.47 | 9.49               | 10.83              | 2.44 | 3.15            | 1.97            | 2.76 | 6.4 lb |
| <b>SVA-LT</b>              |      |                    |                    |      |                 |                 |      |        |
| SVA 15 - 20 mm             | 63   | 237                | 248                | 45   | 60              | 38              | 60   | 1.4 kg |
| SVA (1/2 - 3/4) in.        | 2.48 | 9.33               | 9.76               | 1.77 | 2.36            | 1.5             | 2.36 | 3.1 lb |
| SVA 25 - 40 mm             | 74   | 296                | 330                | 55   | 80              | 50              | 70   | 2.4 kg |
| SVA (1 - 1 1/2) in.        | 2.91 | 11.65              | 12.99              | 2.17 | 3.15            | 1.97            | 2.76 | 5.3 lb |
| <b>SVA-LT, Socket weld</b> |      |                    |                    |      |                 |                 |      |        |
| SVA 32 - 40 mm             | 74   | 303                | 337                | 62   | 80              | 50              | 70   | 2.9 kg |
| SVA (1 1/4 - 1 1/2) in.    | 2.91 | 11.93              | 13.27              | 2.44 | 3.15            | 1.97            | 2.76 | 6.4 lb |

Specified weights are approximate values only.

Dimensions and weights

SVA 15 - 40 (1/2 - 1 1/2 in.) straightway version with cap / hand wheel

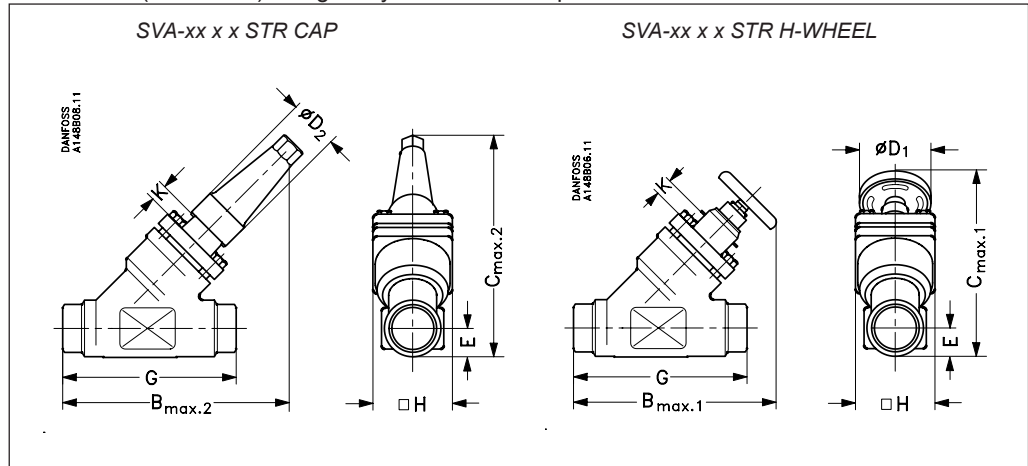

| Valve size | K | C <sub>max.1</sub> | C <sub>max.2</sub> | B <sub>max.1</sub> | B <sub>max.2</sub> | E | G | ØD <sub>1</sub> | ØD <sub>2</sub> | □H | Weight |
|------------|---|--------------------|--------------------|--------------------|--------------------|---|---|-----------------|-----------------|----|--------|
|------------|---|--------------------|--------------------|--------------------|--------------------|---|---|-----------------|-----------------|----|--------|

SVA-ST

|                     |      |      |      |      |      |      |      |      |      |      |        |
|---------------------|------|------|------|------|------|------|------|------|------|------|--------|
| SVA 15 - 20 mm      | 4    | 146  | 141  | 160  | 156  | 20   | 120  | 60   | 38   | 60   | 2.0 kg |
| SVA (1/2 - 3/4) in. | 0.16 | 5.74 | 5.55 | 6.30 | 6.14 | 0.79 | 4.72 | 2.36 | 1.50 | 2.36 | 4.4 lb |
| SVA 25 - 40 mm      | 12   | 199  | 208  | 212  | 222  | 26   | 155  | 80   | 50   | 70   | 3.0 kg |
| SVA (1 - 1 1/2) in. | 0.47 | 7.83 | 8.19 | 8.35 | 8.74 | 1.02 | 6.10 | 3.15 | 1.97 | 2.76 | 6.6 lb |

SVA-ST, Socket weld

|                 |      |      |      |      |      |      |      |      |      |      |        |
|-----------------|------|------|------|------|------|------|------|------|------|------|--------|
| SVA 32 mm       | 12   | 200  | 209  | 212  | 222  | 27.4 | 155  | 80   | 50   | 70   | 3.0 kg |
| SVA (1 1/4) in. | 0.47 | 7.87 | 8.23 | 8.35 | 8.74 | 1.08 | 6.10 | 3.15 | 1.97 | 2.76 | 6.6 lb |
| SVA 40 mm       | 12   | 204  | 213  | 212  | 222  | 31.0 | 155  | 80   | 50   | 70   | 3.0 kg |
| SVA (1 1/2) in. | 0.47 | 8.03 | 8.39 | 8.35 | 8.74 | 1.22 | 6.10 | 3.15 | 1.97 | 2.76 | 6.6 lb |

SVA-LT

|                     |      |      |      |       |       |      |      |      |      |      |        |
|---------------------|------|------|------|-------|-------|------|------|------|------|------|--------|
| SVA 15 - 20 mm      | 63   | 188  | 184  | 202   | 198   | 20   | 120  | 60   | 38   | 60   | 2.0 kg |
| SVA (1/2 - 3/4) in. | 2.48 | 7.40 | 7.24 | 7.95  | 7.80  | 0.79 | 4.72 | 2.36 | 1.50 | 2.36 | 4.4 lb |
| SVA 25 - 40 mm      | 74   | 243  | 252  | 256   | 265   | 26   | 155  | 80   | 50   | 70   | 3.0 kg |
| SVA (1 - 1 1/2) in. | 2.91 | 9.57 | 9.92 | 10.08 | 10.43 | 1.02 | 6.10 | 3.15 | 1.97 | 2.76 | 6.6 lb |

SVA-LT, Socket weld

|                 |      |      |       |       |       |      |      |      |      |      |        |
|-----------------|------|------|-------|-------|-------|------|------|------|------|------|--------|
| SVA 32 mm       | 74   | 244  | 253   | 256   | 265   | 27.4 | 155  | 80   | 50   | 70   | 3.0 kg |
| SVA (1 1/4) in. | 2.91 | 9.61 | 9.96  | 10.08 | 10.43 | 1.08 | 6.10 | 3.15 | 1.97 | 2.76 | 6.6 lb |
| SVA 40 mm       | 74   | 248  | 257   | 256   | 265   | 31.0 | 155  | 80   | 50   | 70   | 3.0 kg |
| SVA (1 1/2) in. | 2.91 | 9.76 | 10.12 | 10.08 | 10.43 | 1.22 | 6.10 | 3.15 | 1.97 | 2.76 | 6.6 lb |

Specified weights are approximate values only.

## Dimensions and weights

SVA 50 - 65 (2 - 2 1/2 in.) in angleway version with cap / hand wheel

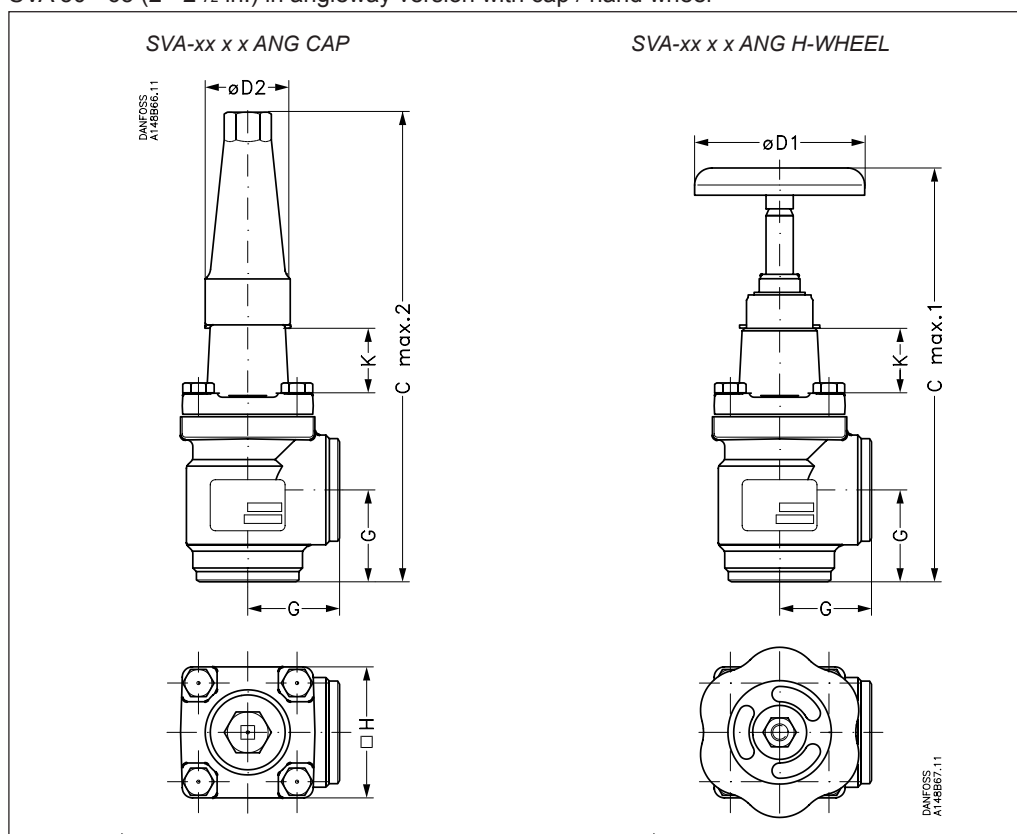

| Valve size                 |     | K    | C <sub>max.1</sub> | C <sub>max.2</sub> | G    | ØD <sub>1</sub> | ØD <sub>2</sub> | □H   | Weight  |
|----------------------------|-----|------|--------------------|--------------------|------|-----------------|-----------------|------|---------|
| <b>SVA-ST</b>              |     |      |                    |                    |      |                 |                 |      |         |
| SVA 50                     | mm  | 35   | 249                | 280                | 60   | 100             | 50              | 77   | 3.2 kg  |
| SVA (2)                    | in. | 1.38 | 9.80               | 11.02              | 2.36 | 3.94            | 1.97            | 3.03 | 7.1 lb  |
| SVA 65                     | mm  | 40   | 280                | 305                | 70   | 100             | 50              | 90   | 4.8 kg  |
| SVA (2 1/2)                | in. | 1.57 | 11.02              | 12.01              | 2.76 | 3.94            | 1.97            | 3.54 | 10.6 lb |
| <b>SVA-ST, Socket weld</b> |     |      |                    |                    |      |                 |                 |      |         |
| SVA 50                     | mm  | 35   | 254                | 285                | 65   | 100             | 50              | 77   | 4.1 kg  |
| SVA (2)                    | in. | 1.38 | 10.00              | 11.22              | 2.56 | 3.94            | 1.97            | 3.03 | 9.0 lb  |
| <b>SVA-LT</b>              |     |      |                    |                    |      |                 |                 |      |         |
| SVA 50                     | mm  | 70   | 284                | 315                | 60   | 100             | 50              | 77   | 3.2 kg  |
| SVA (2)                    | in. | 2.76 | 11.18              | 12.40              | 2.36 | 3.94            | 1.97            | 3.03 | 7.1 lb  |
| SVA 65                     | mm  | 70   | 310                | 335                | 70   | 100             | 50              | 90   | 4.8 kg  |
| SVA (2 1/2)                | in. | 2.76 | 12.20              | 13.19              | 2.76 | 3.94            | 1.97            | 3.54 | 10.6 lb |
| <b>SVA-LT, Socket weld</b> |     |      |                    |                    |      |                 |                 |      |         |
| SVA 50                     | mm  | 70   | 289                | 320                | 65   | 100             | 50              | 77   | 4.1 kg  |
| SVA (2)                    | in. | 2.76 | 11.38              | 12.60              | 2.56 | 3.94            | 1.97            | 3.03 | 9.0 lb  |

Specified weights are approximate values only.

Dimensions and weights SVA 50 - 65 (2 - 2 1/2 in.) in straightway version with cap / hand wheel

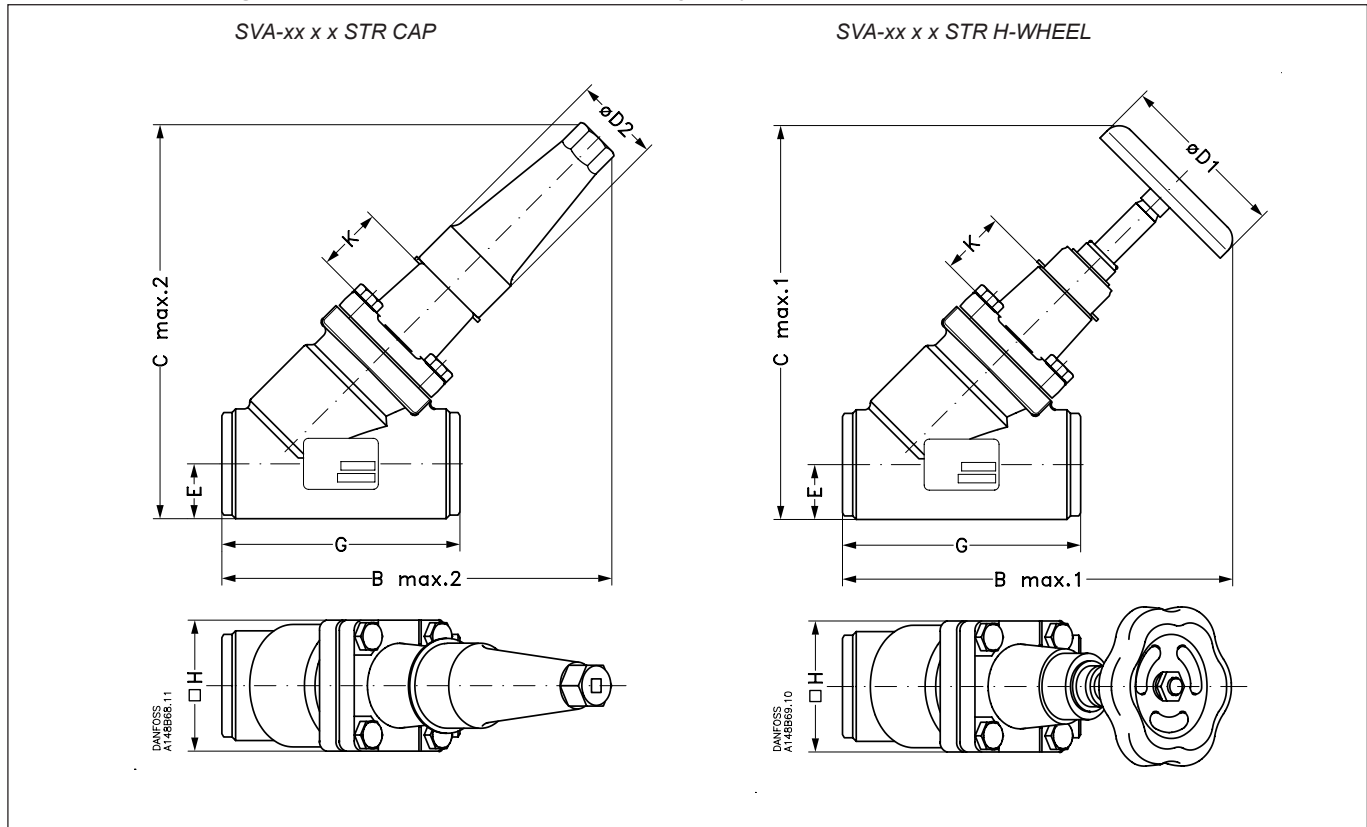

| Valve size                 |     | K    | B <sub>max.1</sub> | B <sub>max.2</sub> | C <sub>max.1</sub> | C <sub>max.2</sub> | E    | G    | ØD <sub>1</sub> | ØD <sub>2</sub> | □H   | Weight  |
|----------------------------|-----|------|--------------------|--------------------|--------------------|--------------------|------|------|-----------------|-----------------|------|---------|
| <b>SVA-ST</b>              |     |      |                    |                    |                    |                    |      |      |                 |                 |      |         |
| SVA 50                     | mm  | 35   | 234                | 234                | 232                | 232                | 32   | 148  | 100             | 50              | 77   | 4.2 kg  |
| SVA (2)                    | in. | 1.38 | 9.21               | 9.21               | 9.13               | 9.13               | 1.26 | 5.83 | 3.94            | 1.97            | 3.03 | 9.3 lb  |
| SVA 65                     | mm  | 40   | 262                | 258                | 262                | 258                | 40   | 176  | 100             | 50              | 90   | 6.3 kg  |
| SVA (2 1/2)                | in. | 1.57 | 10.31              | 10.16              | 10.31              | 10.16              | 1.57 | 6.93 | 3.94            | 1.97            | 3.54 | 13.9 lb |
| <b>SVA-ST, Socket weld</b> |     |      |                    |                    |                    |                    |      |      |                 |                 |      |         |
| SVA 50                     | mm  | 35   | 241                | 241                | 236                | 236                | 37   | 162  | 100             | 50              | 77   | 5.1 kg  |
| SVA (2)                    | in. | 1.38 | 9.49               | 9.49               | 9.29               | 9.29               | 1.46 | 6.38 | 3.94            | 1.97            | 3.03 | 11.2 lb |
| <b>SVA-LT</b>              |     |      |                    |                    |                    |                    |      |      |                 |                 |      |         |
| SVA 50                     | mm  | 70   | 259                | 259                | 257                | 257                | 32   | 148  | 100             | 50              | 77   | 4.2 kg  |
| SVA (2)                    | in. | 2.76 | 10.20              | 10.20              | 10.12              | 10.12              | 1.26 | 5.83 | 3.94            | 1.97            | 3.03 | 9.3 lb  |
| SVA 65                     | mm  | 70   | 284                | 280                | 284                | 280                | 40   | 176  | 100             | 50              | 90   | 6.3 kg  |
| SVA (2 1/2)                | in. | 2.76 | 11.18              | 11.02              | 11.18              | 11.02              | 1.57 | 6.93 | 3.94            | 1.97            | 3.54 | 13.9 lb |
| <b>SVA-LT, Socket weld</b> |     |      |                    |                    |                    |                    |      |      |                 |                 |      |         |
| SVA 50                     | mm  | 70   | 266                | 266                | 261                | 261                | 37   | 62   | 100             | 50              | 77   | 5.1 kg  |
| SVA (2)                    | in. | 2.76 | 10.47              | 10.47              | 10.28              | 10.28              | 1.26 | 6.38 | 3.94            | 1.97            | 3.03 | 11.2 lb |

Specified weights are approximate values only.

## Dimensions and weights

## SVA 80 - 200 (3 - 8 in.) angleway version with cap / hand wheel

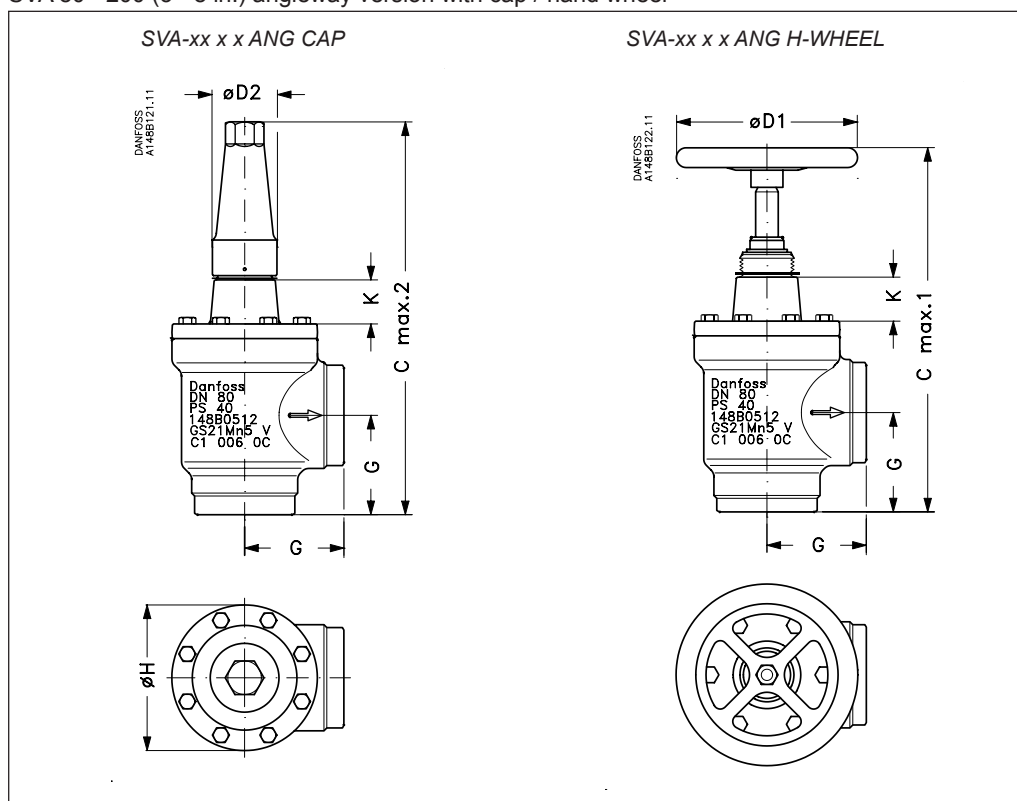

| Valve size    | K        | C <sub>max.1</sub> | C <sub>max.2</sub> | G    | ØD <sub>1</sub> | ØD <sub>2</sub> | ØH    | Weight   |
|---------------|----------|--------------------|--------------------|------|-----------------|-----------------|-------|----------|
| <b>SVA-ST</b> |          |                    |                    |      |                 |                 |       |          |
| SVA 80        | mm 41    | 338                | 353                | 90   | 200             | 58              | 129   | 9.2 kg   |
| SVA (3)       | in. 1.61 | 13.31              | 13.90              | 3.54 | 7.87            | 2.28            | 5.08  | 20.3 lb  |
| SVA 100       | mm 43    | 382                | 388                | 106  | 250             | 58              | 156   | 14.8 kg  |
| SVA (4)       | in. 1.69 | 15.04              | 15.28              | 4.17 | 9.84            | 2.28            | 6.14  | 32.6 lb  |
| SVA 125       | mm 90    | 517                | 533                | 128  | 315             | 74              | 193   | 28.1 kg  |
| SVA (5)       | in. 3.54 | 20.35              | 20.98              | 5.04 | 12.40           | 2.91            | 7.60  | 61.9 lb  |
| SVA 150       | mm 90    | 564                | 568                | 145  | 315             | 74              | 219   | 39.7 kg  |
| SVA (6)       | in. 3.54 | 22.20              | 22.36              | 5.71 | 12.40           | 2.91            | 8.62  | 87.5 lb  |
| SVA 200       | mm 90    | 675                | 678                | 180  | 400             | 86              | 276   | 79.5 kg  |
| SVA (8)       | in. 3.54 | 26.57              | 26.69              | 7.09 | 15.75           | 3.39            | 10.87 | 175.3 lb |
| <b>SVA-LT</b> |          |                    |                    |      |                 |                 |       |          |
| SVA 80        | mm 76    | 373                | 388                | 90   | 200             | 58              | 129   | 9.7 kg   |
| SVA (3)       | in. 3.00 | 14.69              | 15.28              | 3.54 | 7.87            | 2.28            | 5.08  | 21.4 lb  |
| SVA 100       | mm 90    | 432                | 437                | 106  | 250             | 58              | 156   | 15.3 kg  |
| SVA (4)       | in. 3.54 | 17.00              | 17.20              | 4.17 | 9.84            | 2.28            | 6.14  | 33.7 lb  |
| SVA 125       | mm 90    | 517                | 533                | 128  | 315             | 74              | 193   | 28.1 kg  |
| SVA (5)       | in. 3.54 | 20.35              | 20.98              | 5.04 | 12.40           | 2.91            | 7.60  | 61.9 lb  |
| SVA 150       | mm 90    | 564                | 568                | 145  | 315             | 74              | 219   | 39.7 kg  |
| SVA (6)       | in. 3.54 | 22.20              | 22.36              | 5.71 | 12.40           | 2.91            | 8.62  | 87.5 lb  |
| SVA 200       | mm 90    | 675                | 678                | 180  | 400             | 86              | 276   | 79.5 kg  |
| SVA (8)       | in. 3.54 | 26.57              | 26.69              | 7.09 | 15.75           | 3.39            | 10.87 | 175.3 lb |

Specified weights are approximate values only.

Dimensions and weights SVA 80 - 200 (3 - 8 in.) straightway version with cap / hand wheel

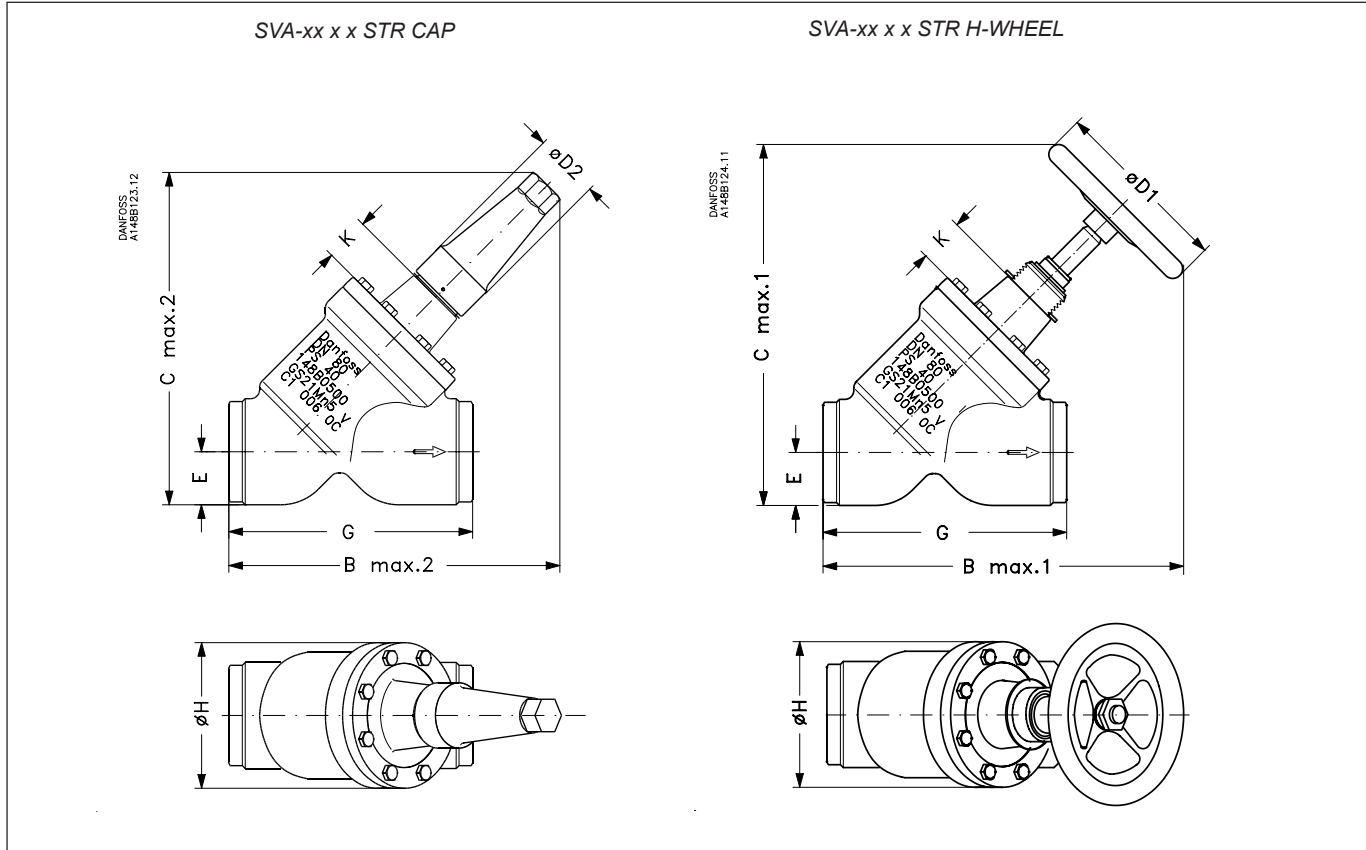

| Valve size    |     | K    | B <sub>max.1</sub> | B <sub>max.2</sub> | C <sub>max.1</sub> | C <sub>max.2</sub> | E    | G     | ØD <sub>1</sub> | ØD <sub>2</sub> | ØH    | Weight   |
|---------------|-----|------|--------------------|--------------------|--------------------|--------------------|------|-------|-----------------|-----------------|-------|----------|
| <b>SVA-ST</b> |     |      |                    |                    |                    |                    |      |       |                 |                 |       |          |
| SVA 80        | mm  | 41   | 340                | 296                | 342                | 298                | 48   | 216   | 200             | 58              | 129   | 10.4 kg  |
| SVA (3)       | in. | 1.61 | 13.38              | 11.65              | 13.46              | 11.73              | 1.89 | 8.50  | 7.87            | 2.28            | 5.08  | 22.9 lb  |
| SVA 100       | mm  | 43   | 400                | 331                | 408                | 339                | 60   | 264   | 250             | 58              | 156   | 17.7 kg  |
| SVA (4)       | in. | 1.69 | 15.75              | 13.03              | 16.06              | 13.35              | 2.36 | 10.39 | 9.84            | 2.28            | 6.14  | 39.0 lb  |
| SVA 125       | mm  | 90   | 526                | 444                | 538                | 456                | 74   | 322   | 315             | 74              | 193   | 32.8 kg  |
| SVA (5)       | in. | 3.54 | 20.71              | 17.48              | 21.18              | 17.95              | 2.91 | 12.68 | 12.40           | 2.91            | 7.60  | 72.3 lb  |
| SVA 150       | mm  | 90   | 572                | 483                | 594                | 505                | 91   | 370   | 315             | 74              | 219   | 60.0 kg  |
| SVA (6)       | in. | 3.54 | 22.52              | 19.02              | 23.39              | 19.88              | 3.58 | 14.57 | 12.40           | 2.91            | 8.62  | 132.3 lb |
| SVA 200       | mm  | 90   | 692                | 579                | 726                | 613                | 117  | 464   | 400             | 86              | 276   | 111.5kg  |
| SVA (8)       | in. | 3.54 | 27.24              | 22.80              | 28.58              | 24.13              | 4.61 | 18.27 | 15.75           | 3.39            | 10.87 | 245.8 lb |
| <b>SVA-LT</b> |     |      |                    |                    |                    |                    |      |       |                 |                 |       |          |
| SVA 80        | mm  | 76   | 365                | 321                | 367                | 323                | 48   | 216   | 200             | 58              | 129   | 10.9 kg  |
| SVA (3)       | in. | 3.00 | 14.37              | 12.64              | 14.45              | 12.72              | 1.89 | 8.50  | 7.87            | 2.28            | 5.08  | 24.0 lb  |
| SVA 100       | mm  | 90   | 435                | 367                | 443                | 375                | 60   | 264   | 250             | 58              | 156   | 18.2 kg  |
| SVA (4)       | in. | 3.54 | 17.13              | 14.45              | 17.44              | 14.76              | 2.36 | 10.39 | 9.84            | 2.28            | 6.14  | 40.1 lb  |
| SVA 125       | mm  | 90   | 526                | 444                | 538                | 456                | 74   | 322   | 315             | 74              | 193   | 32.8 kg  |
| SVA (5)       | in. | 3.54 | 20.71              | 17.48              | 21.18              | 17.95              | 2.91 | 12.68 | 12.40           | 2.91            | 7.60  | 72.3 lb  |
| SVA 150       | mm  | 90   | 572                | 483                | 594                | 505                | 91   | 370   | 315             | 74              | 219   | 60.0 kg  |
| SVA (6)       | in. | 3.54 | 22.52              | 19.02              | 23.39              | 19.88              | 3.58 | 14.57 | 12.40           | 2.91            | 8.62  | 132.3 lb |
| SVA 200       | mm  | 90   | 692                | 579                | 726                | 613                | 117  | 464   | 400             | 86              | 276   | 111.5kg  |
| SVA (8)       | in. | 3.54 | 27.24              | 22.80              | 28.58              | 24.13              | 4.61 | 18.27 | 15.75           | 3.39            | 10.87 | 245.8 lb |

Specified weights are approximate values only.

**Ordering**

Please note that the type codes only serve to identify the valves, some of which may not form part of the standard product range. For further information please contact your local Danfoss Sales Company.

*Type codes*

| Valve type                                       | SVA  | Stop Valve   |
|--|--|--|
| Nominal size in mm                               |  | Available connections<br>A/D SOC FPT   |
| (valve size measured on the connection diameter) | <b>15</b>  | DN 15 (1/2)  |
|  | <b>20</b>  | DN 20 (3/4)  |
|  | <b>25</b>  | DN 25 (1)  |
|  | <b>32</b>  | DN 32 (1 1/4)  |
|  | <b>40</b>  | DN 40 (1 1/2)  |
|  | <b>50</b>  | DN 50 (2)  |
|  | <b>65</b>  | DN 65 (2 1/2)  |
|  | <b>80</b>  | DN 80 (3)  |
|  | <b>100</b>                                       | DN 100 (4)   |
|  | <b>125</b>                                       | DN 125 (5)   |
|  | <b>150</b>                                       | DN 150 (6)   |
|  | <b>200</b>                                       | DN 200 (8)   |
| Connections                                      | <b>A</b><br><b>D</b><br><b>SOC</b><br><b>FPT</b> | Butt-weld connection: ANSI B 36.10 schedule 80, DN 15 - 40 (1/2 - 1 1/2 in.)<br>Butt-weld connection: ANSI B 36.10 schedule 40, DN 50 - 200 (2 - 8 in.)<br>Butt-weld connection: DIN 2448<br>Socket weld: ANSI B 16.11<br>Female Pipe Thread NPT: ANSI/ASME B 1.20.1 |
| Valve housing                                    | <b>ANG</b><br><b>STR</b>                         | Angle flow<br>Straight flow  |
| Other equipment                                  | <b>H-WHEEL</b><br><b>CAP</b>                     | Hand wheel<br>Cap  |

**Important!**

Where products need to be certified according to specific certification societies or where higher pressures are required, the relevant information should be included at the time of order.

**Ordering**  
(cont.)

Example:  
SVA-ST 20 DIN angleway with  
hand wheel = **148B3441**

**Important!**

Where products need to be certified according to specific certification societies or where higher pressures are required, the relevant information should be included at the time of order.

The table below is used to identify the valve required.

| Standard version |     |      |             |
|------------------|-----|------|-------------|
| Angleway         |     |      |             |
| Size             |     | Type | Code number |
| mm               | in. |      |             |

| DIN |       |                          |          |
|-----|-------|--------------------------|----------|
| 15  | 1/2   | SVA-ST 15 D ANG H-WHEEL  | 148B3361 |
| 15  | 1/2   | SVA-ST 15 D ANG CAP      | 148B3362 |
| 20  | 3/4   | SVA-ST 20 D ANG H-WHEEL  | 148B3441 |
| 20  | 3/4   | SVA-ST 20 D ANG CAP      | 148B3442 |
| 25  | 1     | SVA-ST 25 D ANG H-WHEEL  | 148B3521 |
| 25  | 1     | SVA-ST 25 D ANG CAP      | 148B3522 |
| 32  | 1 1/4 | SVA-ST 32 D ANG H-WHEEL  | 148B3601 |
| 32  | 1 1/4 | SVA-ST 32 D ANG CAP      | 148B3602 |
| 40  | 1 1/2 | SVA-ST 40 D ANG H-WHEEL  | 148B3681 |
| 40  | 1 1/2 | SVA-ST 40 D ANG CAP      | 148B3682 |
| 50  | 2     | SVA-ST 50 D ANG H-WHEEL  | 148B3032 |
| 50  | 2     | SVA-ST 50 D ANG CAP      | 148B3033 |
| 65  | 2 1/2 | SVA-ST 65 D ANG H-WHEEL  | 148B3044 |
| 65  | 2 1/2 | SVA-ST 65 D ANG CAP      | 148B3045 |
| 80  | 3     | SVA-ST 80 D ANG H-WHEEL  | 148B3061 |
| 80  | 3     | SVA-ST 80 D ANG CAP      | 148B3062 |
| 100 | 4     | SVA-ST 100 D ANG H-WHEEL | 148B3101 |
| 100 | 4     | SVA-ST 100 D ANG CAP     | 148B3102 |
| 125 | 5     | SVA-ST 125 D ANG H-WHEEL | 148B3141 |
| 125 | 5     | SVA-ST 125 D ANG CAP     | 148B3142 |
| 150 | 6     | SVA-ST 150 D ANG H-WHEEL | 148B3181 |
| 150 | 6     | SVA-ST 150 D ANG CAP     | 148B3182 |
| 200 | 8     | SVA-ST 200 D ANG H-WHEEL | 148B3221 |
| 200 | 8     | SVA-ST 200 D ANG CAP     | 148B3222 |

| ANSI |       |                          |          |
|------|-------|--------------------------|----------|
| 15   | 1/2   | SVA-ST 15 A ANG H-WHEEL  | 148B3371 |
| 15   | 1/2   | SVA-ST 15 A ANG CAP      | 148B3372 |
| 20   | 3/4   | SVA-ST 20 A ANG H-WHEEL  | 148B3451 |
| 20   | 3/4   | SVA-ST 20 A ANG CAP      | 148B3452 |
| 25   | 1     | SVA-ST 25 A ANG H-WHEEL  | 148B3531 |
| 25   | 1     | SVA-ST 25 A ANG CAP      | 148B3532 |
| 32   | 1 1/4 | SVA-ST 32 A ANG H-WHEEL  | 148B3611 |
| 32   | 1 1/4 | SVA-ST 32 A ANG CAP      | 148B3612 |
| 40   | 1 1/2 | SVA-ST 40 A ANG H-WHEEL  | 148B3691 |
| 40   | 1 1/2 | SVA-ST 40 A ANG CAP      | 148B3692 |
| 50   | 2     | SVA-ST 50 A ANG H-WHEEL  | 148B3034 |
| 50   | 2     | SVA-ST 50 A ANG CAP      | 148B3035 |
| 65   | 2 1/2 | SVA-ST 65 A ANG H-WHEEL  | 148B3046 |
| 65   | 2 1/2 | SVA-ST 65 A ANG CAP      | 148B3047 |
| 80   | 3     | SVA-ST 80 A ANG H-WHEEL  | 148B3071 |
| 80   | 3     | SVA-ST 80 A ANG CAP      | 148B3072 |
| 100  | 4     | SVA-ST 100 A ANG H-WHEEL | 148B3111 |
| 100  | 4     | SVA-ST 100 A ANG CAP     | 148B3112 |
| 125  | 5     | SVA-ST 125 A ANG H-WHEEL | 148B3151 |
| 125  | 5     | SVA-ST 125 A ANG CAP     | 148B3152 |
| 150  | 6     | SVA-ST 150 A ANG H-WHEEL | 148B3191 |
| 150  | 6     | SVA-ST 150 A ANG CAP     | 148B3192 |
| 200  | 8     | SVA-ST 200 A ANG H-WHEEL | 148B3231 |
| 200  | 8     | SVA-ST 200 A ANG CAP     | 148B3232 |

| SOC |       |                           |          |
|-----|-------|---------------------------|----------|
| 15  | 1/2   | SVA-ST 15 SOC ANG H-WHEEL | 148B3381 |
| 15  | 1/2   | SVA-ST 15 SOC ANG CAP     | 148B3382 |
| 20  | 3/4   | SVA-ST 20 SOC ANG H-WHEEL | 148B3461 |
| 20  | 3/4   | SVA-ST 20 SOC ANG CAP     | 148B3462 |
| 25  | 1     | SVA-ST 25 SOC ANG H-WHEEL | 148B3541 |
| 25  | 1     | SVA-ST 25 SOC ANG CAP     | 148B3542 |
| 32  | 1 1/4 | SVA-ST 32 SOC ANG H-WHEEL | 148B3621 |
| 32  | 1 1/4 | SVA-ST 32 SOC ANG CAP     | 148B3622 |
| 40  | 1 1/2 | SVA-ST 40 SOC ANG H-WHEEL | 148B3701 |
| 40  | 1 1/2 | SVA-ST 40 SOC ANG CAP     | 148B3702 |
| 50  | 2     | SVA-ST 50 SOC ANG H-WHEEL | 148B3036 |
| 50  | 2     | SVA-ST 50 SOC ANG CAP     | 148B3037 |

| FPT |       |                           |          |
|-----|-------|---------------------------|----------|
| 15  | 1/2   | SVA-ST 15 FPT ANG H-WHEEL | 148B3391 |
| 15  | 1/2   | SVA-ST 15 FPT ANG CAP     | 148B3392 |
| 20  | 3/4   | SVA-ST 20 FPT ANG H-WHEEL | 148B3471 |
| 20  | 3/4   | SVA-ST 20 FPT ANG CAP     | 148B3472 |
| 25  | 1     | SVA-ST 25 FPT ANG H-WHEEL | 148B3551 |
| 25  | 1     | SVA-ST 25 FPT ANG CAP     | 148B3552 |
| 32  | 1 1/4 | SVA-ST 32 FPT ANG H-WHEEL | 148B3631 |
| 32  | 1 1/4 | SVA-ST 32 FPT ANG CAP     | 148B3632 |

| Standard version |     |      |             |
|------------------|-----|------|-------------|
| Straightway      |     |      |             |
| Size             |     | Type | Code number |
| mm               | in. |      |             |

| DIN |       |                          |          |
|-----|-------|--------------------------|----------|
| 15  | 1/2   | SVA-ST 15 D STR H-WHEEL  | 148B3401 |
| 15  | 1/2   | SVA-ST 15 D STR CAP      | 148B3402 |
| 20  | 3/4   | SVA-ST 20 D STR H-WHEEL  | 148B3481 |
| 20  | 3/4   | SVA-ST 20 D STR CAP      | 148B3482 |
| 25  | 1     | SVA-ST 25 D STR H-WHEEL  | 148B3561 |
| 25  | 1     | SVA-ST 25 D STR CAP      | 148B3562 |
| 32  | 1 1/4 | SVA-ST 32 D STR H-WHEEL  | 148B3641 |
| 32  | 1 1/4 | SVA-ST 32 D STR CAP      | 148B3642 |
| 40  | 1 1/2 | SVA-ST 40 D STR H-WHEEL  | 148B3711 |
| 40  | 1 1/2 | SVA-ST 40 D STR CAP      | 148B3712 |
| 50  | 2     | SVA-ST 50 D STR H-WHEEL  | 148B3038 |
| 50  | 2     | SVA-ST 50 D STR CAP      | 148B3039 |
| 65  | 2 1/2 | SVA-ST 65 D STR H-WHEEL  | 148B3050 |
| 65  | 2 1/2 | SVA-ST 65 D STR CAP      | 148B3051 |
| 80  | 3     | SVA-ST 80 D STR H-WHEEL  | 148B3081 |
| 80  | 3     | SVA-ST 80 D STR CAP      | 148B3082 |
| 100 | 4     | SVA-ST 100 D STR H-WHEEL | 148B3121 |
| 100 | 4     | SVA-ST 100 D STR CAP     | 148B3122 |
| 125 | 5     | SVA-ST 125 D STR H-WHEEL | 148B3161 |
| 125 | 5     | SVA-ST 125 D STR CAP     | 148B3162 |
| 150 | 6     | SVA-ST 150 D STR H-WHEEL | 148B3201 |
| 150 | 6     | SVA-ST 150 D STR CAP     | 148B3202 |
| 200 | 8     | SVA-ST 200 D STR H-WHEEL | 148B3241 |
| 200 | 8     | SVA-ST 200 D STR CAP     | 148B3242 |

| ANSI |       |                          |          |
|------|-------|--------------------------|----------|
| 15   | 1/2   | SVA-ST 15 A STR H-WHEEL  | 148B3411 |
| 15   | 1/2   | SVA-ST 15 A STR CAP      | 148B3412 |
| 20   | 3/4   | SVA-ST 20 A STR H-WHEEL  | 148B3491 |
| 20   | 3/4   | SVA-ST 20 A STR CAP      | 148B3492 |
| 25   | 1     | SVA-ST 25 A STR H-WHEEL  | 148B3571 |
| 25   | 1     | SVA-ST 25 A STR CAP      | 148B3572 |
| 32   | 1 1/4 | SVA-ST 32 A STR H-WHEEL  | 148B3651 |
| 32   | 1 1/4 | SVA-ST 32 A STR CAP      | 148B3652 |
| 40   | 1 1/2 | SVA-ST 40 A STR H-WHEEL  | 148B3721 |
| 40   | 1 1/2 | SVA-ST 40 A STR CAP      | 148B3722 |
| 50   | 2     | SVA-ST 50 A STR H-WHEEL  | 148B3040 |
| 50   | 2     | SVA-ST 50 A STR CAP      | 148B3041 |
| 65   | 2 1/2 | SVA-ST 65 A STR H-WHEEL  | 148B3052 |
| 65   | 2 1/2 | SVA-ST 65 A STR CAP      | 148B3053 |
| 80   | 3     | SVA-ST 80 A STR H-WHEEL  | 148B3091 |
| 80   | 3     | SVA-ST 80 A STR CAP      | 148B3092 |
| 100  | 4     | SVA-ST 100 A STR H-WHEEL | 148B3131 |
| 100  | 4     | SVA-ST 100 A STR CAP     | 148B3132 |
| 125  | 5     | SVA-ST 125 A STR H-WHEEL | 148B3171 |
| 125  | 5     | SVA-ST 125 A STR CAP     | 148B3172 |
| 150  | 6     | SVA-ST 150 A STR H-WHEEL | 148B3211 |
| 150  | 6     | SVA-ST 150 A STR CAP     | 148B3212 |
| 200  | 8     | SVA-ST 200 A STR H-WHEEL | 148B3251 |
| 200  | 8     | SVA-ST 200 A STR CAP     | 148B3252 |

| SOC |       |                           |          |
|-----|-------|---------------------------|----------|
| 15  | 1/2   | SVA-ST 15 SOC STR H-WHEEL | 148B3421 |
| 15  | 1/2   | SVA-ST 15 SOC STR CAP     | 148B3422 |
| 20  | 3/4   | SVA-ST 20 SOC STR H-WHEEL | 148B3501 |
| 20  | 3/4   | SVA-ST 20 SOC STR CAP     | 148B3502 |
| 25  | 1     | SVA-ST 25 SOC STR H-WHEEL | 148B3581 |
| 25  | 1     | SVA-ST 25 SOC STR CAP     | 148B3582 |
| 32  | 1 1/4 | SVA-ST 32 SOC STR H-WHEEL | 148B3661 |
| 32  | 1 1/4 | SVA-ST 32 SOC STR CAP     | 148B3662 |
| 40  | 1 1/2 | SVA-ST 40 SOC STR H-WHEEL | 148B3731 |
| 40  | 1 1/2 | SVA-ST 40 SOC STR CAP     | 148B3732 |
| 50  | 2     | SVA-ST 50 SOC STR H-WHEEL | 148B3042 |
| 50  | 2     | SVA-ST 50 SOC STR CAP     | 148B3043 |

| FPT |       |                           |          |
|-----|-------|---------------------------|----------|
| 15  | 1/2   | SVA-ST 15 FPT STR H-WHEEL | 148B3431 |
| 15  | 1/2   | SVA-ST 15 FPT STR CAP     | 148B3432 |
| 20  | 3/4   | SVA-ST 20 FPT STR H-WHEEL | 148B3511 |
| 20  | 3/4   | SVA-ST 20 FPT STR CAP     | 148B3512 |
| 25  | 1     | SVA-ST 25 FPT STR H-WHEEL | 148B3591 |
| 25  | 1     | SVA-ST 25 FPT STR CAP     | 148B3592 |
| 32  | 1 1/4 | SVA-ST 32 FPT STR H-WHEEL | 148B3671 |
| 32  | 1 1/4 | SVA-ST 32 FPT STR CAP     | 148B3672 |

D = Butt-weld DIN  
A = Butt-weld ANSI  
SOC = Socket welding  
FPT = Inside pipe thread

ANG = Angle-way  
STR = Straight-way

CAP = Cap  
H-WHEEL = Hand wheel

**Ordering**  
(cont.)

Example:  
SVA-LT 20 ANSI Angleway Cap  
= **148B3455**

**Important!**

Where products need to be certified according to specific certification societies or where higher pressures are required, the relevant information should be included at the time of order.

The table below is used to identify the valve required.

| Low temperature version |     |      |             |
|-------------------------|-----|------|-------------|
| Angleway                |     |      |             |
| Size                    |     | Type | Code number |
| mm                      | in. |      |             |

| DIN |       |                          |          |
|-----|-------|--------------------------|----------|
| 15  | 1/2   | SVA-LT 15 D ANG H-WHEEL  | 148B3364 |
| 15  | 1/2   | SVA-LT 15 D ANG CAP      | 148B3365 |
| 20  | 3/4   | SVA-LT 20 D ANG H-WHEEL  | 148B3444 |
| 20  | 3/4   | SVA-LT 20 D ANG CAP      | 148B3445 |
| 25  | 1     | SVA-LT 25 D ANG H-WHEEL  | 148B3524 |
| 25  | 1     | SVA-LT 25 D ANG CAP      | 148B3525 |
| 32  | 1 1/4 | SVA-LT 32 D ANG H-WHEEL  | 148B3604 |
| 32  | 1 1/4 | SVA-LT 32 D ANG CAP      | 148B3605 |
| 40  | 1 1/2 | SVA-LT 40 D ANG H-WHEEL  | 148B3684 |
| 40  | 1 1/2 | SVA-LT 40 D ANG CAP      | 148B3685 |
| 50  | 2     | SVA-LT 50 D ANG H-WHEEL  | 148B3264 |
| 50  | 2     | SVA-LT 50 D ANG CAP      | 148B3265 |
| 65  | 2 1/2 | SVA-LT 65 D ANG H-WHEEL  | 148B3324 |
| 65  | 2 1/2 | SVA-LT 65 D ANG CAP      | 148B3325 |
| 80  | 3     | SVA-LT 80 D ANG H-WHEEL  | 148B3064 |
| 80  | 3     | SVA-LT 80 D ANG CAP      | 148B3065 |
| 100 | 4     | SVA-LT 100 D ANG H-WHEEL | 148B3104 |
| 100 | 4     | SVA-LT 100 D ANG CAP     | 148B3105 |
| 125 | 5     | SVA-LT 125 D ANG H-WHEEL | 148B3144 |
| 125 | 5     | SVA-LT 125 D ANG CAP     | 148B3145 |
| 150 | 6     | SVA-LT 150 D ANG H-WHEEL | 148B3184 |
| 150 | 6     | SVA-LT 150 D ANG CAP     | 148B3185 |
| 200 | 8     | SVA-LT 200 D ANG H-WHEEL | 148B3224 |
| 200 | 8     | SVA-LT 200 D ANG CAP     | 148B3225 |

| ANSI |       |                          |          |
|------|-------|--------------------------|----------|
| 15   | 1/2   | SVA-LT 15 A ANG H-WHEEL  | 148B3374 |
| 15   | 1/2   | SVA-LT 15 A ANG CAP      | 148B3375 |
| 20   | 3/4   | SVA-LT 20 A ANG H-WHEEL  | 148B3454 |
| 20   | 3/4   | SVA-LT 20 A ANG CAP      | 148B3455 |
| 25   | 1     | SVA-LT 25 A ANG H-WHEEL  | 148B3534 |
| 25   | 1     | SVA-LT 25 A ANG CAP      | 148B3535 |
| 32   | 1 1/4 | SVA-LT 32 A ANG H-WHEEL  | 148B3614 |
| 32   | 1 1/4 | SVA-LT 32 A ANG CAP      | 148B3615 |
| 40   | 1 1/2 | SVA-LT 40 A ANG H-WHEEL  | 148B3694 |
| 40   | 1 1/2 | SVA-LT 40 A ANG CAP      | 148B3695 |
| 50   | 2     | SVA-LT 50 A ANG H-WHEEL  | 148B3274 |
| 50   | 2     | SVA-LT 50 A ANG CAP      | 148B3275 |
| 65   | 2 1/2 | SVA-LT 65 A ANG H-WHEEL  | 148B3334 |
| 65   | 2 1/2 | SVA-LT 65 A ANG CAP      | 148B3335 |
| 80   | 3     | SVA-LT 80 A ANG H-WHEEL  | 148B3074 |
| 80   | 3     | SVA-LT 80 A ANG CAP      | 148B3075 |
| 100  | 4     | SVA-LT 100 A ANG H-WHEEL | 148B3114 |
| 100  | 4     | SVA-LT 100 A ANG CAP     | 148B3115 |
| 125  | 5     | SVA-LT 125 A ANG H-WHEEL | 148B3154 |
| 125  | 5     | SVA-LT 125 A ANG CAP     | 148B3155 |
| 150  | 6     | SVA-LT 150 A ANG H-WHEEL | 148B3194 |
| 150  | 6     | SVA-LT 150 A ANG CAP     | 148B3195 |
| 200  | 8     | SVA-LT 200 A ANG H-WHEEL | 148B3234 |
| 200  | 8     | SVA-LT 200 A ANG CAP     | 148B3235 |

| SOC |       |                           |          |
|-----|-------|---------------------------|----------|
| 15  | 1/2   | SVA-LT 15 SOC ANG H-WHEEL | 148B3384 |
| 15  | 1/2   | SVA-LT 15 SOC ANG CAP     | 148B3385 |
| 20  | 3/4   | SVA-LT 20 SOC ANG H-WHEEL | 148B3464 |
| 20  | 3/4   | SVA-LT 20 SOC ANG CAP     | 148B3465 |
| 25  | 1     | SVA-LT 25 SOC ANG H-WHEEL | 148B3544 |
| 25  | 1     | SVA-LT 25 SOC ANG CAP     | 148B3545 |
| 32  | 1 1/4 | SVA-LT 32 SOC ANG H-WHEEL | 148B3624 |
| 32  | 1 1/4 | SVA-LT 32 SOC ANG CAP     | 148B3625 |
| 40  | 1 1/2 | SVA-LT 40 SOC ANG H-WHEEL | 148B3704 |
| 40  | 1 1/2 | SVA-LT 40 SOC ANG CAP     | 148B3705 |
| 50  | 2     | SVA-LT 50 SOC ANG H-WHEEL | 148B3284 |
| 50  | 2     | SVA-LT 50 SOC ANG CAP     | 148B3285 |

| FPT |       |                           |          |
|-----|-------|---------------------------|----------|
| 15  | 1/2   | SVA-LT 15 FPT ANG H-WHEEL | 148B3394 |
| 15  | 1/2   | SVA-LT 15 FPT ANG CAP     | 148B3395 |
| 20  | 3/4   | SVA-LT 20 FPT ANG H-WHEEL | 148B3474 |
| 20  | 3/4   | SVA-LT 20 FPT ANG CAP     | 148B3475 |
| 25  | 1     | SVA-LT 25 FPT ANG H-WHEEL | 148B3554 |
| 25  | 1     | SVA-LT 25 FPT ANG CAP     | 148B3555 |
| 32  | 1 1/4 | SVA-LT 32 FPT ANG H-WHEEL | 148B3634 |
| 32  | 1 1/4 | SVA-LT 32 FPT ANG CAP     | 148B3635 |

| Low temperature version |     |      |             |
|-------------------------|-----|------|-------------|
| Straightway             |     |      |             |
| Size                    |     | Type | Code number |
| mm                      | in. |      |             |

| DIN |       |                          |          |
|-----|-------|--------------------------|----------|
| 15  | 1/2   | SVA-LT 15 D STR H-WHEEL  | 148B3404 |
| 15  | 1/2   | SVA-LT 15 D STR CAP      | 148B3405 |
| 20  | 3/4   | SVA-LT 20 D STR H-WHEEL  | 148B3484 |
| 20  | 3/4   | SVA-LT 20 D STR CAP      | 148B3485 |
| 25  | 1     | SVA-LT 25 D STR H-WHEEL  | 148B3564 |
| 25  | 1     | SVA-LT 25 D STR CAP      | 148B3565 |
| 32  | 1 1/4 | SVA-LT 32 D STR H-WHEEL  | 148B3644 |
| 32  | 1 1/4 | SVA-LT 32 D STR CAP      | 148B3645 |
| 40  | 1 1/2 | SVA-LT 40 D STR H-WHEEL  | 148B3714 |
| 40  | 1 1/2 | SVA-LT 40 D STR CAP      | 148B3715 |
| 50  | 2     | SVA-LT 50 D STR H-WHEEL  | 148B3294 |
| 50  | 2     | SVA-LT 50 D STR CAP      | 148B3295 |
| 65  | 2 1/2 | SVA-LT 65 D STR H-WHEEL  | 148B3344 |
| 65  | 2 1/2 | SVA-LT 65 D STR CAP      | 148B3345 |
| 80  | 3     | SVA-LT 80 D STR H-WHEEL  | 148B3084 |
| 80  | 3     | SVA-LT 80 D STR CAP      | 148B3085 |
| 100 | 4     | SVA-LT 100 D STR H-WHEEL | 148B3124 |
| 100 | 4     | SVA-LT 100 D STR CAP     | 148B3125 |
| 125 | 5     | SVA-LT 125 D STR H-WHEEL | 148B3164 |
| 125 | 5     | SVA-LT 125 D STR CAP     | 148B3165 |
| 150 | 6     | SVA-LT 150 D STR H-WHEEL | 148B3204 |
| 150 | 6     | SVA-LT 150 D STR CAP     | 148B3205 |
| 200 | 8     | SVA-LT 200 D STR H-WHEEL | 148B3244 |
| 200 | 8     | SVA-LT 200 D STR CAP     | 148B3245 |

| ANSI |       |                          |          |
|------|-------|--------------------------|----------|
| 15   | 1/2   | SVA-LT 15 A STR H-WHEEL  | 148B3414 |
| 15   | 1/2   | SVA-LT 15 A STR CAP      | 148B3415 |
| 20   | 3/4   | SVA-LT 20 A STR H-WHEEL  | 148B3494 |
| 20   | 3/4   | SVA-LT 20 A STR CAP      | 148B3495 |
| 25   | 1     | SVA-LT 25 A STR H-WHEEL  | 148B3574 |
| 25   | 1     | SVA-LT 25 A STR CAP      | 148B3575 |
| 32   | 1 1/4 | SVA-LT 32 A STR H-WHEEL  | 148B3654 |
| 32   | 1 1/4 | SVA-LT 32 A STR CAP      | 148B3655 |
| 40   | 1 1/2 | SVA-LT 40 A STR H-WHEEL  | 148B3724 |
| 40   | 1 1/2 | SVA-LT 40 A STR CAP      | 148B3725 |
| 50   | 2     | SVA-LT 50 A STR H-WHEEL  | 148B3304 |
| 50   | 2     | SVA-LT 50 A STR CAP      | 148B3305 |
| 65   | 2 1/2 | SVA-LT 65 A STR H-WHEEL  | 148B3354 |
| 65   | 2 1/2 | SVA-LT 65 A STR CAP      | 148B3355 |
| 80   | 3     | SVA-LT 80 A STR H-WHEEL  | 148B3094 |
| 80   | 3     | SVA-LT 80 A STR CAP      | 148B3095 |
| 100  | 4     | SVA-LT 100 A STR H-WHEEL | 148B3134 |
| 100  | 4     | SVA-LT 100 A STR CAP     | 148B3135 |
| 125  | 5     | SVA-LT 125 A STR H-WHEEL | 148B3174 |
| 125  | 5     | SVA-LT 125 A STR CAP     | 148B3175 |
| 150  | 6     | SVA-LT 150 A STR H-WHEEL | 148B3214 |
| 150  | 6     | SVA-LT 150 A STR CAP     | 148B3215 |
| 200  | 8     | SVA-LT 200 A STR H-WHEEL | 148B3254 |
| 200  | 8     | SVA-LT 200 A STR CAP     | 148B3255 |

| SOC |       |                           |          |
|-----|-------|---------------------------|----------|
| 15  | 1/2   | SVA-LT 15 SOC STR H-WHEEL | 148B3424 |
| 15  | 1/2   | SVA-LT 15 SOC STR CAP     | 148B3425 |
| 20  | 3/4   | SVA-LT 20 SOC STR H-WHEEL | 148B3504 |
| 20  | 3/4   | SVA-LT 20 SOC STR CAP     | 148B3505 |
| 25  | 1     | SVA-LT 25 SOC STR H-WHEEL | 148B3584 |
| 25  | 1     | SVA-LT 25 SOC STR CAP     | 148B3585 |
| 32  | 1 1/4 | SVA-LT 32 SOC STR H-WHEEL | 148B3664 |
| 32  | 1 1/4 | SVA-LT 32 SOC STR CAP     | 148B3665 |
| 40  | 1 1/2 | SVA-LT 40 SOC STR H-WHEEL | 148B3734 |
| 40  | 1 1/2 | SVA-LT 40 SOC STR CAP     | 148B3735 |
| 50  | 2     | SVA-LT 50 SOC STR H-WHEEL | 148B3314 |
| 50  | 2     | SVA-LT 50 SOC STR CAP     | 148B3315 |

| FPT |       |                           |          |
|-----|-------|---------------------------|----------|
| 15  | 1/2   | SVA-LT 15 FPT STR H-WHEEL | 148B3434 |
| 15  | 1/2   | SVA-LT 15 FPT STR CAP     | 148B3435 |
| 20  | 3/4   | SVA-LT 20 FPT STR H-WHEEL | 148B3514 |
| 20  | 3/4   | SVA-LT 20 FPT STR CAP     | 148B3515 |
| 25  | 1     | SVA-LT 25 FPT STR H-WHEEL | 148B3594 |
| 25  | 1     | SVA-LT 25 FPT STR CAP     | 148B3595 |
| 32  | 1 1/4 | SVA-LT 32 FPT STR H-WHEEL | 148B3674 |
| 32  | 1 1/4 | SVA-LT 32 FPT STR CAP     | 148B3675 |

D = Butt-weld DIN  
A = Butt-weld ANSI  
SOC = Socket welding  
FPT = Inside pipe thread

ANG = Angle-way  
STR = Straight-way

CAP = Cap  
H-WHEEL = Hand wheel